

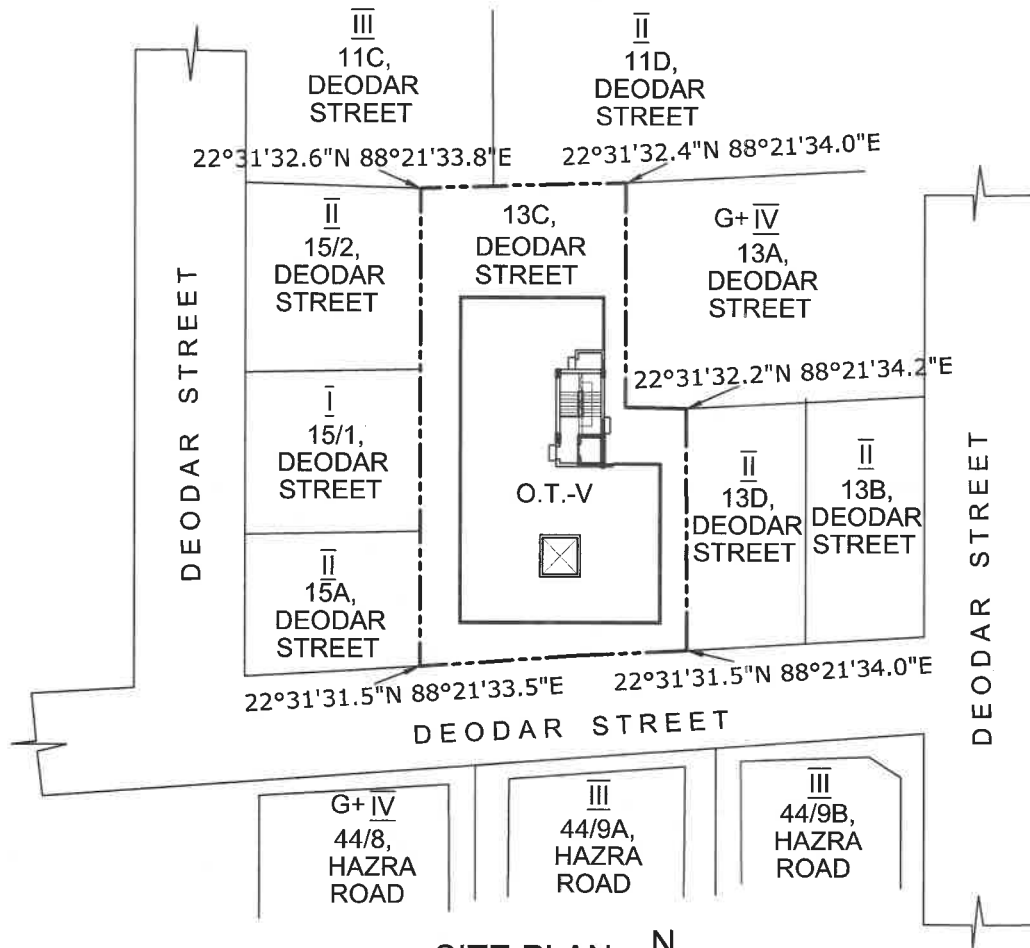

SITE PLAN SHOWING LATITUDE & LONGITUDE FOR PROPOSED
 G+IV STORIED(HT.-15.475MT.) RESIDENTIAL
 BUILDING AT- 13C, DEODAR STREET, KOLKATA- 700019,
 WARD NO.-69, BOROUGH NO.-VIII, P.S.- BALLYGUNGE.

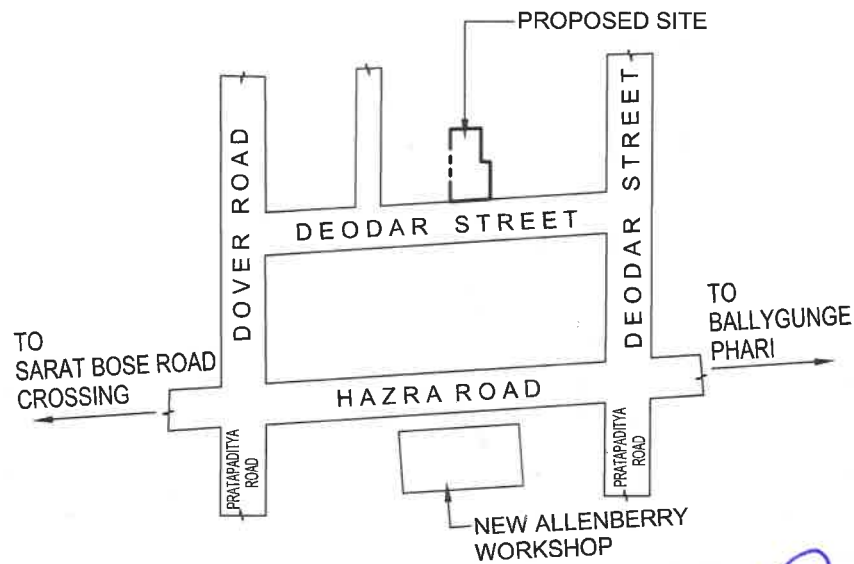

SITE PLAN 
 SCALE-1:600



LOCATION PLAN 
 SCALE-1:4000

For Swastic Projects Pvt. Ltd.

Director